

# BOULEVARD 88

项目资料  
给指定的联合销售机构

# 推销词

沿着 **Orchard Boulevard** 的唯一全新永久住宅项目，  
在 **The Singapore EDITION hotel\*** 之上

\*新加坡第一，与时尚的内饰和拔尖的服务而闻名。

这家豪华精品酒店是行业里与众不同者，Ian Schrager 创立的品牌，也属于 Marriott International 的一部分。

# 顾问详细信息

设计师	Safdie Architects   DP Architects Pte Ltd
景观顾问	Sitetectonix Pte Ltd
建筑师	Kajima Overseas Asia Pte Ltd
机械与电力工程师	Squire Mech Pte Ltd
土木与结构工程师	Meinhardt (Singapore) Pte Ltd
估算师	Arcadis Singapore Pte Ltd
项目室内设计师	AXIS ID Pte Ltd



## 2019 Wolf Prize

Moshe Safdie named 2019 Laureate in  
Architecture  
January 16, 2019

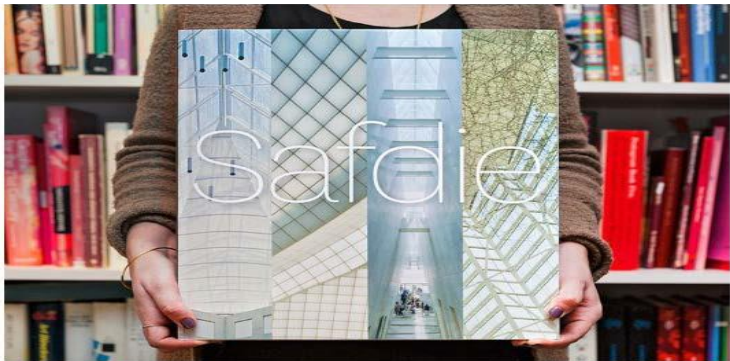

50th Anniversary Monograph  
October 1, 2015

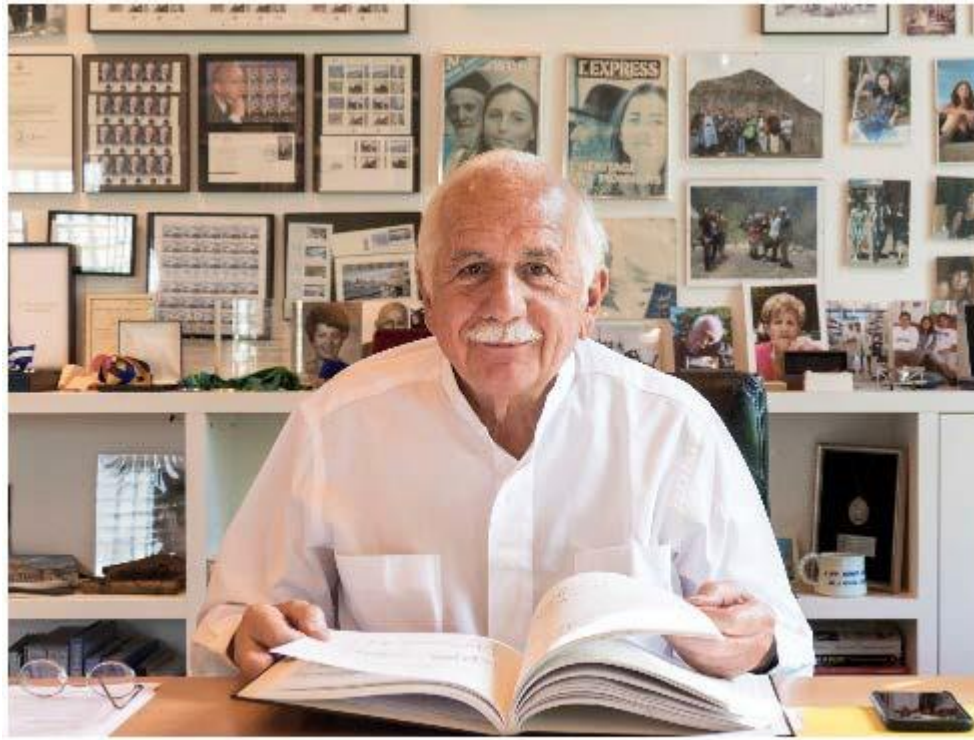

Moshe Safdie, FAIA, FRAIC, OAA, SIA



Fast Company 2018 Innovation  
by Design Awards

Jewel Changi Airport is Finalist in Space,  
Places, and Cities  
September 14, 2018

设计师 - MOSHE SAFDIE

---



Marina Bay Sands - Hotel and SkyPark  
Singapore

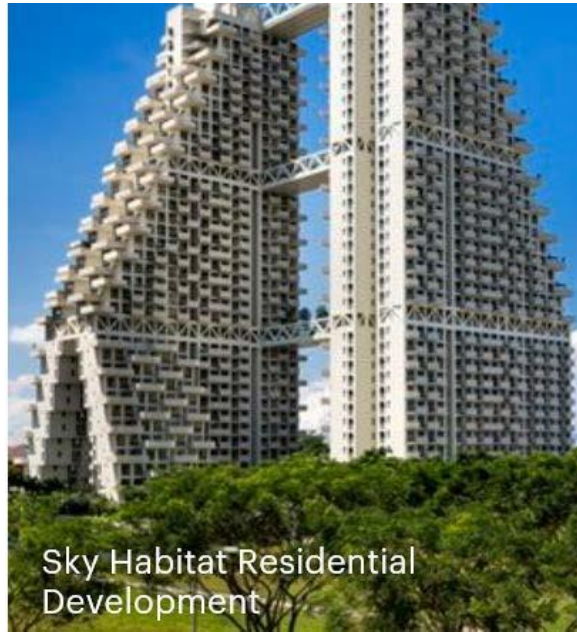

Sky Habitat Residential  
Development



Jewel Changi Airport  
Singapore



Marina Bay Sands Integrated Resort  
Singapore

设计师 - MOSHE SAFDIE  
(项目, 新加坡)

---



设计师 - MOSHE SAFDIE  
(项目, 中国)

---

# 项目详情

项目名	Boulevard 88 铂瑞雅居
开发商	Granmil Holdings Pte Ltd (A Joint venture amongst Hong Leong Holdings Limited (UEN No. 1968002902), City Developments Limited (UEN No. 196300316Z & Lea Investments Pte Ltd (UEN No. 199308144N))
地址	38 Cuscaden Road [Hotel] 86 Orchard Boulevard, Singapore 248655 [Residential] 88 Orchard Boulevard, Singapore 248656 [Residential]
地区	10
总单位	154
地契	永久
场地面积 (酒店和住宅)	12,127.2平方米/ 130,537平方英尺
描述	拥有酒店和豪华住宅公寓以及6层地下停车场的永久项目。 住宅区包括两座28层的塔楼，提供154间豪华单位。
停车场位	总数: 322位 地下层1: 酒店下车区和车道 地下层2 和地下层5: 211位 (只供居民) 地下层6: 111位 (只供酒店客人) 两个入口从 Orchard Boulevard 和 Cuscaden Road
住宅单位混合	总数: 154单位 2+书房 (1,313平方英尺): 50单位 3-卧室 (1,776平方英尺): 50单位 4-卧室 (2,766 – 2,799平方英尺): 50单位 阁楼 (5,673 – 6,049平方英尺): 4单位

# 定位图

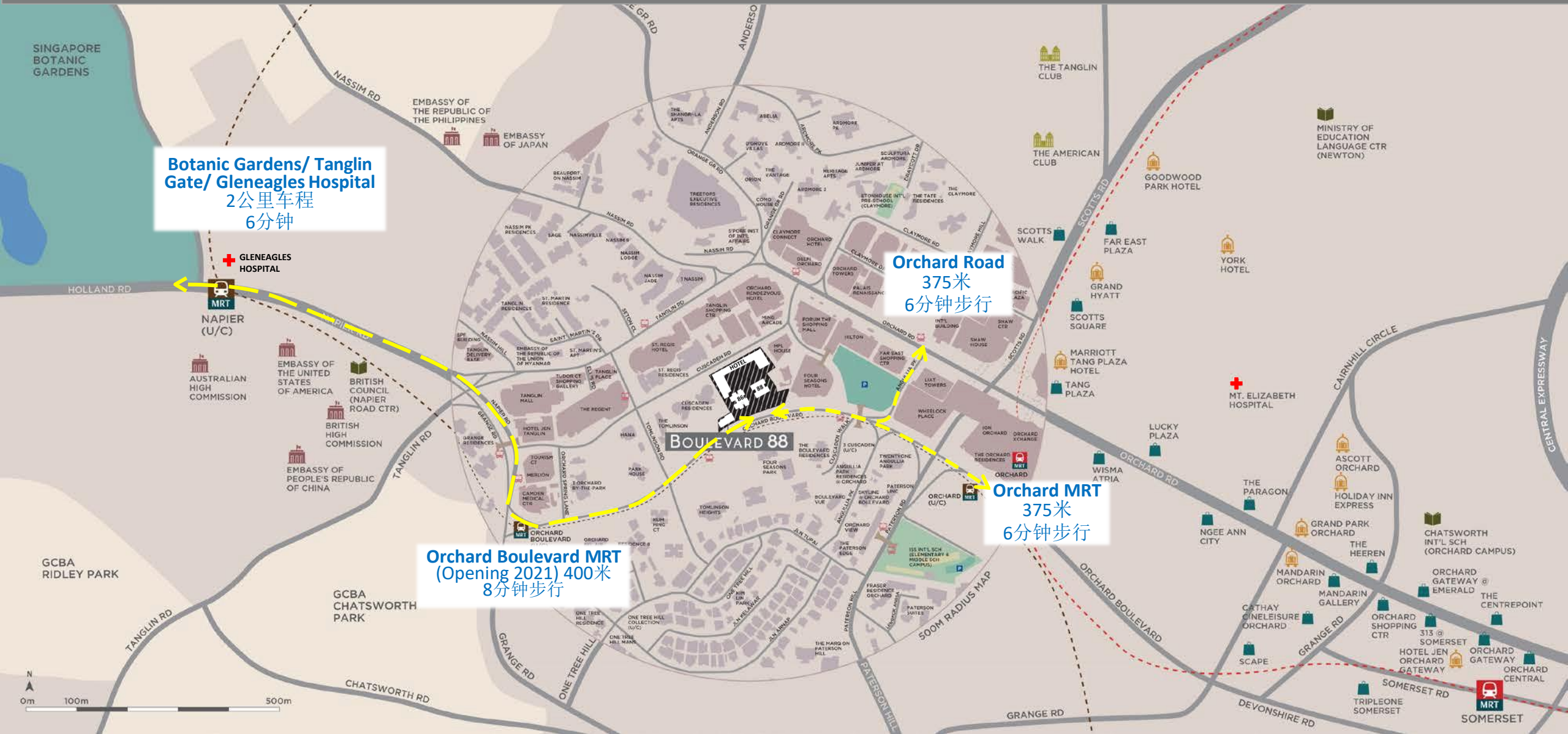

## BOULEVARD 88



# 示意图

		86 ORCHARD BOULEVARD S(248655)				88 ORCHARD BOULEVARD S(248656)	
LEVEL/UNIT		01	02	03	04	05	06
LOWER ROOF		PH1 (#28-01)		PH2 (#28-02)		MSE SPACES	
28							
27		B1a (#27-01)	B1 (#27-02)*	A1 (#27-03)*	A1 (#27-04)	C2b (#27-05)	C1 (#27-06)
26		B2a (#26-01)	B2 (#26-02)*	A2 (#26-03)*	A2 (#26-04)	C2b (#26-05)	C2 (#26-06)
25		B1a (#25-01)	B1 (#25-02)*	A1 (#25-03)*	A1 (#25-04)	C2b (#25-05)	C1 (#25-06)
24		B2a (#24-01)	B2 (#24-02)*	A2 (#24-03)*	A2 (#24-04)	C2b (#24-05)	C2 (#24-06)
23		B1a (#23-01)	B1 (#23-02)*	A1 (#23-03)*	A1 (#23-04)	C2b (#23-05)	C1 (#23-06)
22		B2a (#22-01)	B2 (#22-02)*	A2 (#22-03)*	A2 (#22-04)	C2b (#22-05)	C2 (#22-06)
21		B1a (#21-01)	B1 (#21-02)*	A1 (#21-03)*	A1 (#21-04)	C2b (#21-05)	C1 (#21-06)
20		B2a (#20-01)	B2 (#20-02)*	A2 (#20-03)*	A2 (#20-04)	C2b (#20-05)	C2 (#20-06)
19		B1a (#19-01)	B1 (#19-02)*	A1 (#19-03)*	A1 (#19-04)	C2b (#19-05)	C1 (#19-06)
18		B2a (#18-01)	B2 (#18-02)*	A2 (#18-03)*	A2 (#18-04)	C2b (#18-05)	C2 (#18-06)
17		B1a (#17-01)	B1 (#17-02)*	A1 (#17-03)*	A1 (#17-04)	C2b (#17-05)	C1 (#17-06)
16		B2a (#16-01)	B2 (#16-02)*	A2 (#16-03)*	A2 (#16-04)	C2b (#16-05)	C2 (#16-06)
15		B1a (#15-01)	B1 (#15-02)*	A1 (#15-03)*	A1 (#15-04)	C2b (#15-05)	C1 (#15-06)
14		B2 (#14-01)	B2 (#14-02)*	A2 (#14-03)*	A2 (#14-04)	C2b (#14-05)	C2 (#14-06)
13		B1 (#13-01)	B1 (#13-02)*	A1 (#13-03)*	A1 (#13-04)	C2b (#13-05)	C1 (#13-06)
12		B2 (#12-01)	B2 (#12-02)*	A2 (#12-03)*	A2 (#12-04)	C2b (#12-05)	C2 (#12-06)
11		B1 (#11-01)	B1 (#11-02)*	A1 (#11-03)*	A1 (#11-04)	C2b (#11-05)	C1 (#11-06)
10		B2 (#10-01)	B2 (#10-02)*	A2 (#10-03)*	A2 (#10-04)	C2b (#10-05)	C2 (#10-06)
9		B1 (#09-01)	B1 (#09-02)*	A1 (#09-03)*	A1 (#09-04)	C2b (#09-05)	C1 (#09-06)
8		B2 (#08-01)	B2 (#08-02)*	A2 (#08-03)*	A2 (#08-04)	C2b (#08-05)	C2 (#08-06)
7		B1 (#07-01)	B1 (#07-02)*	A1 (#07-03)*	A1 (#07-04)	C2b (#07-05)	C1 (#07-06)
6		B2 (#06-01)	B2 (#06-02)*	A2 (#06-03)*	A2 (#06-04)	C2b (#06-05)	C2 (#06-06)
5		B1 (#05-01)	B1 (#05-02)*	A1 (#05-03)*	A1 (#05-04)	C2b (#05-05)	C1 (#05-06)
4		B2 (#04-01)	B2 (#04-02)*	A2 (#04-03)*	A2 (#04-04)	C2b (#04-05)	C2 (#04-06)
3		B1 (#03-01)	B1 (#03-02)*	A1 (#03-03)*	A1 (#03-04)	C2b (#03-05)	C1 (#03-06)
		MSE SPACES				MSE SPACES	
2		THE PATIO					
1		ARRIVAL LOBBY					
0.2		CARPARK / LOBBY					
0.1		CARPARK / LOBBY					

2 BEDROOM + STUDY

TYPE A1, A2

3 BEDROOM

TYPE B1, B1a, B2, B2a

4 BEDROOM

TYPE C1, C1b, C2, C2b, C3, C3b

PENTHOUSE

TYPE PH1, PH2, PH3, PH4

\*a denotes units with Security Screening

\* denotes mirror image units

Subject to authority's inspection on-site, the requirement might be extended to additional unit types.

# 位置图 - 1楼



## LEGEND

- ① ARRIVAL LOBBY
- ② VERDE GARDEN I
- ③ VERDE GARDEN II
- ④ GUARD HOUSE
- ⑤ RESIDENTIAL LOBBY

BOULEVARD 88

Please note that the boundary lines of the units set out herein are not a representation of the boundary lines of the actual units. Unit type shading applies to typical units. Positions of sculptures are illustrative and subject to change.

资料倾向变迁。不得流通。

# 位置图 - 2楼



## LEGEND

- 6 PLAY PATIO
- 7 PATIO LOUNGE
- 8 FITNESS PATIO
- 9 YOGA PATIO

Please note that the boundary lines of the units set out herein are not a representation of the boundary lines of the actual units. Unit type shading applies to typical units. Positions of sculptures are illustrative and subject to change.

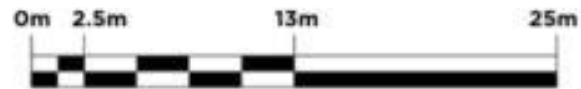

# 位置图 - 天空大道

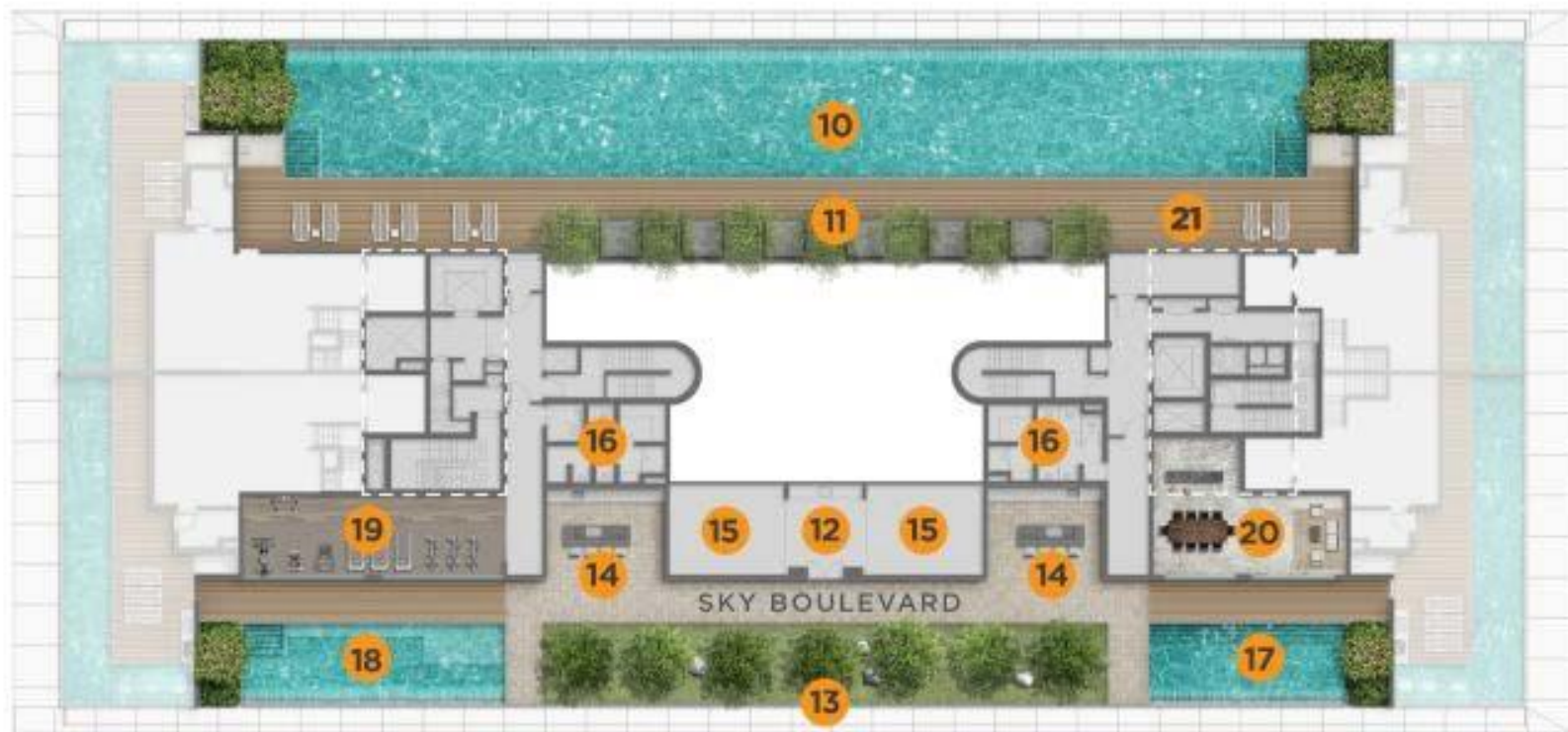

## LEGEND

- 10 INFINITY SKY POOL
- 11 SKY CABANA
- 12 CONCIERGE
- 13 SKY LAWN
- 14 SKY KITCHEN I & II
- 15 SKY LOUNGE I & II
- 16 CHANGING ROOM & STEAM ROOM
- 17 PLAY POOL
- 18 SKY SPA
- 19 SKY GYM
- 20 SKY CLUB (FUNCTION ROOM)
- 21 PRIVE LOUNGE
- ☐ WATER TANK LOCATION

Please note that the boundary lines of the units set out herein are not a representation of the boundary lines of the actual units. Unit type shading applies to typical units. Positions of sculptures are illustrative and subject to change.

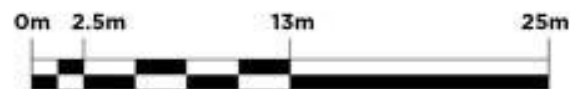

# 典型: 2+书房布置 (估计1,313平方英尺)

## TYPE A1

122 SQM / 1313 SQ FT

\*#03-04, #05-04, #07-04,  
#09-04, #11-04, #13-04,  
#15-04, #17-04, #19-04,  
#21-04, #23-04, #25-04,  
#27-04

\*#03-03\*, #05-03\*, #07-03\*,  
#09-03\*, #11-03\*, #13-03\*,  
#15-03\*, #17-03\*, #19-03\*,  
#21-03\*, #23-03\*, #25-03\*,  
#27-03\*

\*Mirror Image

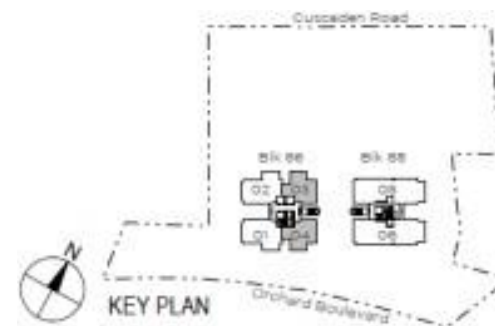

# 典型：3卧室布置 (估计1,776平方英尺)

## TYPE B1

165 SQM / 1776 SQ

#03-01, #05-01, #07-01,  
#09-01, #11-01, #13-01

#03-02\*, #05-02\*, #07-02\*,  
#09-02\*, #11-02\*, #13-02\*,  
#15-02\*, #17-02\*, #19-02\*,  
#21-02\*, #23-02\*, #25-02\*,  
#27-02\*

\*Mirror Image

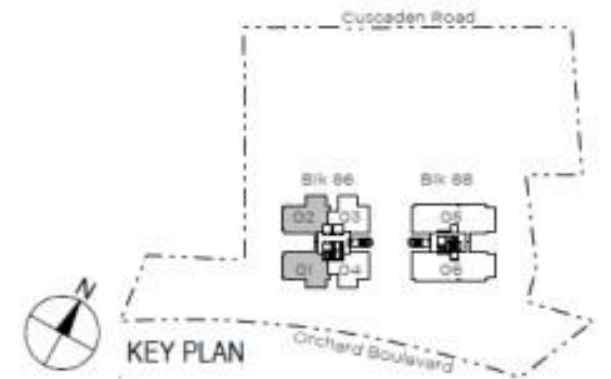

# 典型：4卧室 (估计2,766 – 2,799平方英尺)

## TYPE C1

257 SQM / 2766 SQ

#05-06, #07-06, #09-06,  
#11-06, #13-06, #15-06,  
#17-06, #19-06, #21-06,  
#23-06, #25-06, #27-06

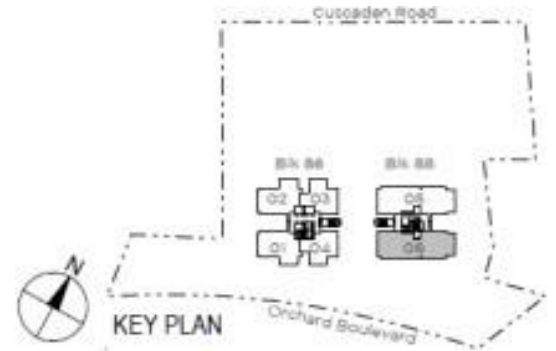
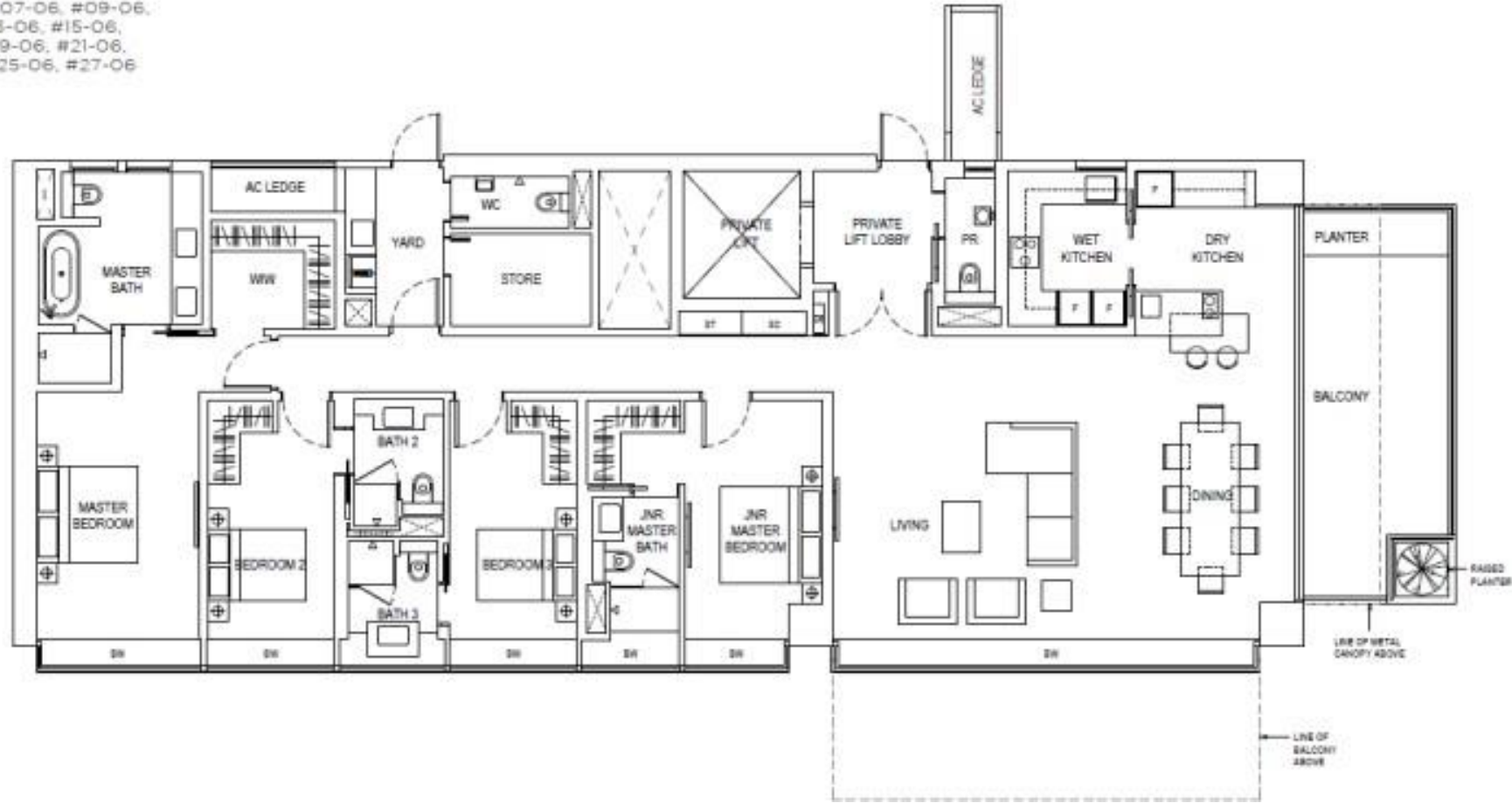

# BOULEVARD 88

资料倾向变迁。不得流通。

谢谢